

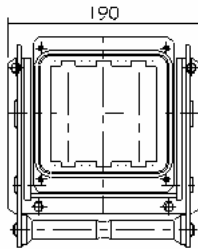

Radiation Tolerant Rectangular Connectors
Data Sheet

129/12/400-1
3-way Bulkhead Plug



129/12/401-1
2-way Bulkhead Plug

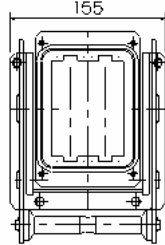

129/12/402-1
Single-way Bulkhead Plug

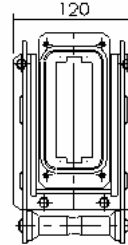

Vertically Mounted Plug
(Side View)

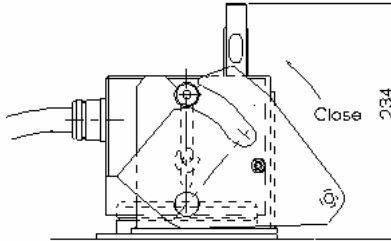
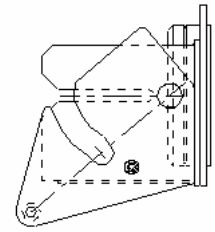

Horizontally Mounted Plug
In-line Socket

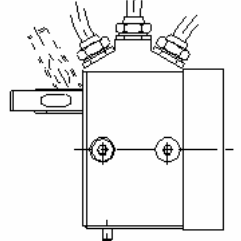

In-line Socket
Showing Alternative Grip Position

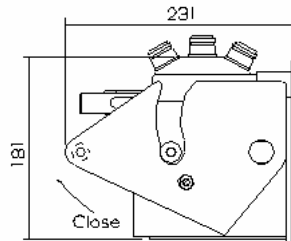

Vertically Mounted Plug &
In-line Socket

Radiation tolerant to 10⁸ Rads
Stainless steel housing
Waterproof to IP 66
Keyed to prevent incorrect connections
Alternate insert types can be incorporated
Part of a range of products designed for use by large power manipulators and MSMs
Adopted by Sellafield Ltd as an Intermediate Level Waste (ILW) standard product

Ordering Code

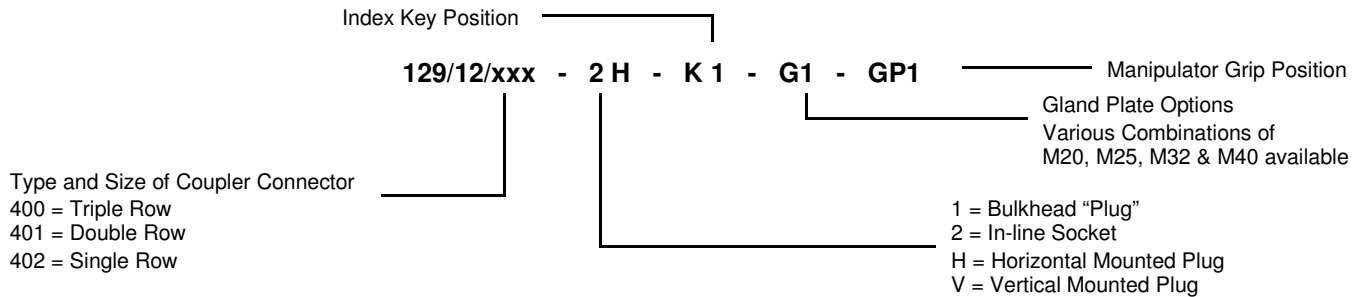

Please contact us to discuss your application.

Inserts:- List separately if required :-

Han 24E:- 24 Contacts 16A @ 380V ac Max + Earth
Han 108DD:- 108 Contacts 10A @ 250V ac Max + Earth
Han 16Hve :- 16 Contacts 16A @ 500V ac Max + Earth + 2 Relay Contacts



Ennerdale Mill Business Park, Egremont, Cumbria, CA22 2NL
Tel (0) 1946 823502 Fax (0) 1946 821065

A subsidiary of James Fisher and Sons Public Limited Company
Registered Number 5165202 Vat Registration Number 154552370

Registered Office Fisher House Michaelson Road Barrow-in-Furness Cumbria LA14 1HR